

CST-16V models

QUADRUPLE BALANCED MAGNETIC CONTACTS



CST-16V



Magnetic contact with integrated vibration sensor Flying lead

Coded Sensor Technology, a TSec exclusive, allows the production of matching magnet/sensor pairs: for the first time, a passive sensor is able to recognise its own magnet. Attempts at using a magnet different from the coded one will be signalled by the opening of a dedicated, 24h tamper circuit. CST contacts, even with such advanced features, are fully passive, and can be interfaced with any existing alarm panel. CST-16V models contain a magnetic vibration/impact detector, for enhanced anti-burglar protection. They are also fully potted, for internal or external use.

- Design based on patented Magnasphere® technology, used under license
- Magnetic anti-masking from both the outside and inside of the protected perimeter
- Matching magnet/sensor pairs
- High resistance anodized aluminum case
- Modular cable exit system
- Suitable for in-line or right-angled installations without any extra mounting plates
- Patented magnetic pry-tamper mechanism for simpler installation
- Integrated vibration/impact detector for enhanced protection
- Fully potted for indoor or outdoor installation
- Optional stainless steel sheath CLH-2G 10 (10m) or CLH- 2G 5 (5m)

Ordering guide

SENSOR	D MAX	X MAX	PACKAGING
CST-16V	Ferrous materials: 6 mm Other materials: 6 mm	2 mm	Sensor, magnet, spacers, cable guide, cable guide for PVC sheath, screw covers: 1 set

TECHNICAL CHARACTERISTICS

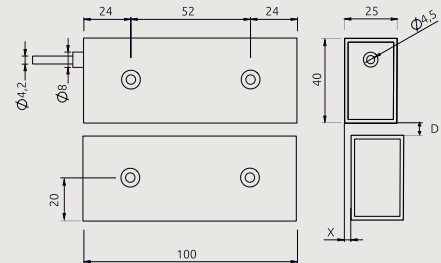

CASE
ABS + anodised aluminium

MAGNET
Neodymium

POTTING
Fully potted

ELECTRICAL CONTACT
Closed with magnet in secure position

ELECTRICAL PARAMETERS
30 VDC max, 250 mA, 0.25 W

TERMINALS
300cm 6x0.22 flying lead

RESISTANCE TO MECHANICAL SHOCKS
Up to 100g acceleration

SECURITY
Compatible Grade 3 EN 50131-2-6



ENVIRONMENTAL CLASS
Compatible Class IV EN 50131-2-6