

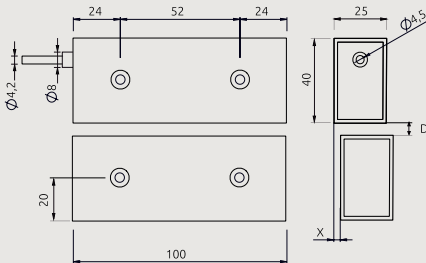

# CST-15-M models

QUADRUPLE BALANCED MAGNETIC CONTACTS

## TECHNICAL CHARACTERISTICS



**CASE**  
ABS + anodised aluminium

**MAGNET**  
Neodymium

**POTTING**  
Internal circuitry

**ELECTRICAL CONTACT**  
Closed with magnet in secure position

**ELECTRICAL PARAMETERS**  
30 VDC max, 250 mA, 0.25 W

**TERMINALS**  
Screw terminals

**RESISTANCE TO MECHANICAL SHOCKS**  
Up to 100g acceleration

**SECURITY**  
Certified Grade 3 EN 50131-2-6



**ENVIRONMENTAL CLASS**  
Certified Class II EN 50131-2-6

## CST-15-M



### Magnetic contact Screw terminals

Coded Sensor Technology, a TSec exclusive, allows the production of matching magnet/sensor pairs: for the first time, a passive sensor is able to recognise its own magnet. Attempts at using a magnet different from the coded one will be signalled by the opening of a dedicated, 24h tamper circuit. CST contacts, even with such advanced features, are fully passive, and can be interfaced with any existing alarm panel. CST-15-M models come with screw terminals, for faster installation times.

- Design based on patented Magnasphere® technology, used under license
- Magnetic anti-masking from both the outside and inside of the protected perimeter
- Matching magnet/sensor pairs
- High resistance anodized aluminum case
- Modular cable exit system
- Suitable for in-line or right-angled installations without any extra mounting plates
- Patented magnetic pry-tamper mechanism for simpler installation
- Screw terminals for fast installation

## Ordering guide

SENSOR	D MAX	X MAX	PACKAGING
<b>CST-15-M</b>	Ferrous materials: 6 mm Other materials: 6 mm	2 mm	Sensor, magnet, spacers, cable guide, cable guide for PVC sheath, screw covers: 1 set